

CAN Open remote control

433MHZ 6 Push Buttons remote control CANOpen receive unit

Thanks to the compact dimension, and the CAN BUS technology this solution can find multiple applications in numbers of different markets

- Marine
- Agriculture
- Earthmoving
- Transport
- Lifting
- Mining
-

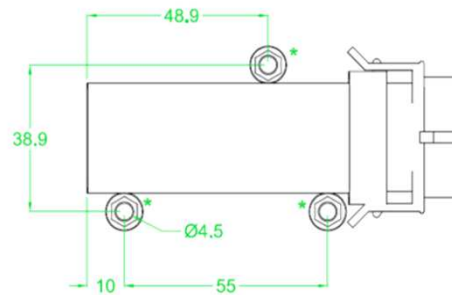
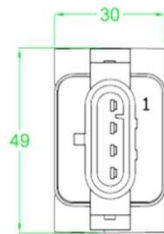

Storage temperature	from - 40 °C to +85 °C (from - 40 °f to +185 °f)
Operating temperature	from - 20 °C to +80 °C (from - 4 °f to +158 °f)
Sealing	IP66
Power Supply Voltage	9 - 32v full operational, suitable for machine battery
Connectivity	1 CAN bus 2.0B High Speed (11 or 29 bit identifier) ISO11898-2 comply
EMC standards by 89/336 Ce CE Mark – EMC (Emission/ Immunity)	EN 61000 - 6 - 3 (2006) EN 55011 (RF Emission) EN 61000 - 6 - 2 (2005) EN 61000 - 4 - 2 (electrostatic Discharge) EN 61000 - 4 - 3 (radio frequency) EN 61000 - 4 - 4 (burst) EN 61000 - 4 - 6 (Conducted disturbance)
Connection:	1: +VB 2 : -VB 3:CANH 4:CANL